







BIG 10K NETWORK

- 1 VIP Gear Check
- 2 Hospitality
- 3 Waterslides
- 4 DIRECTV
- 5 Bungee Run
- 6 Alumni Tents
- 7 T-Shirt Tent
- 8 Partner Tents
- 9 Volunteer Check-In
- 10 Hydration
- 11 Info Tent
- 12 Entertainment Stage
- 13 Food & Beverage
- 14 Bike Valet
- 15 Gear Check

-  Medical Facility
-  Toilets
-  Info Tower
-  Zero Waste Station
-  5K Course
-  10K Course



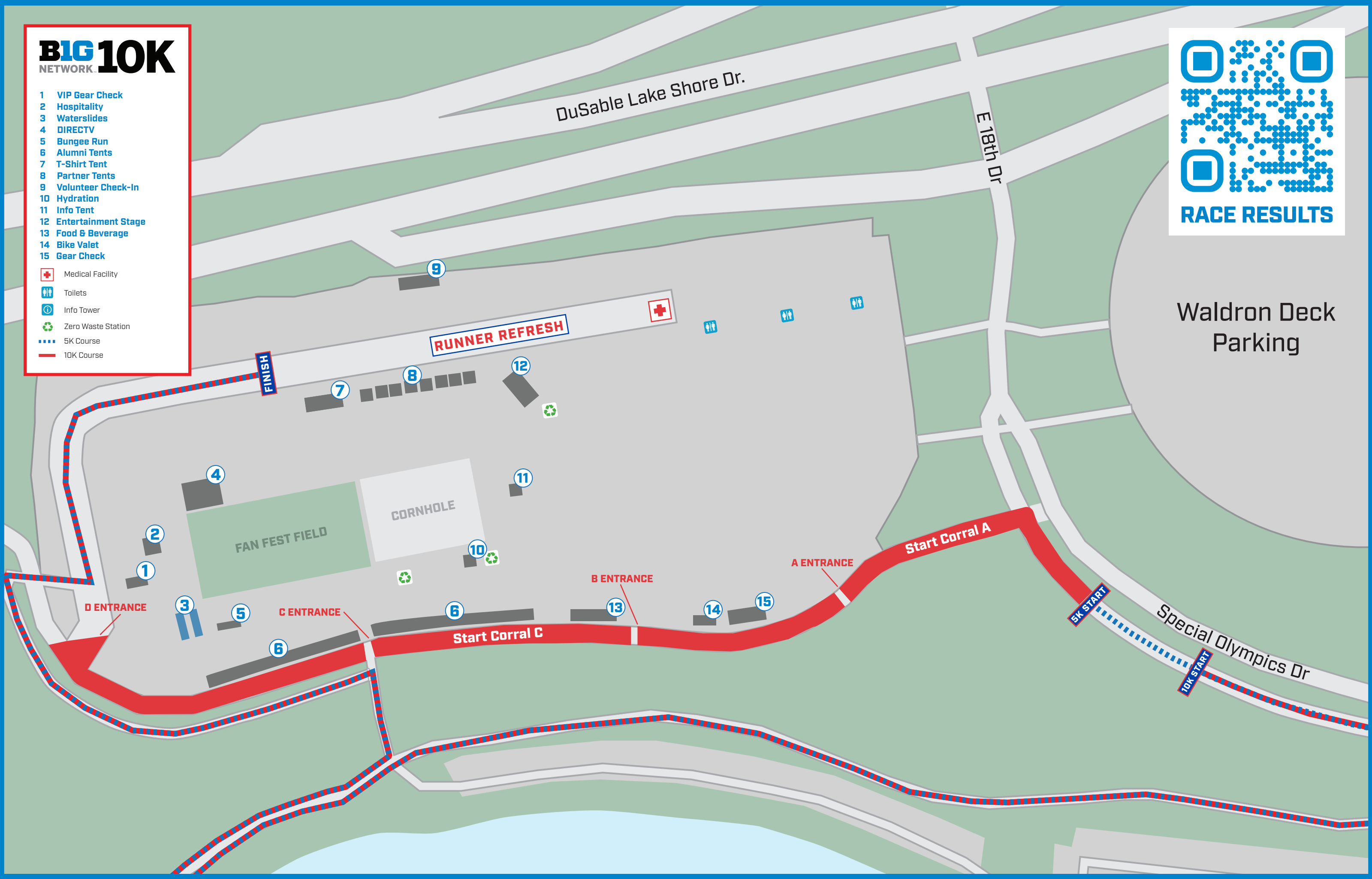
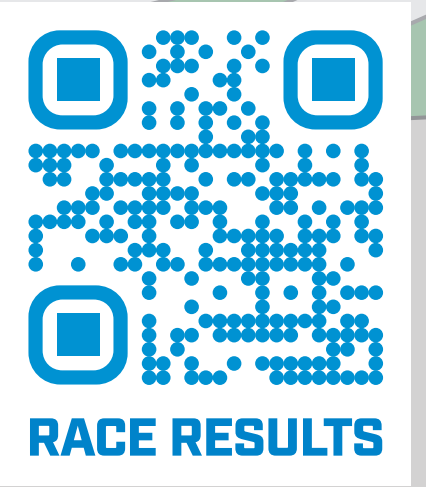

WHAT TIME DOES THE RACE START?

The BTN Big 10K will kick off at 7 a.m. with the 10K followed by the 5K at 8:15 a.m

CAN I PURCHASE AN ADDITIONAL SCHOOL SPECIFIC SHIRT?

Additional shirts will be available for sale post-race on Saturday, July 13 for \$20. Post-race sales are based on remaining inventory, and we cannot guarantee all school shirts or sizes will be available for purchase

POST-RACE TAILGATE

The BTN Big 10K Post-Race Tailgate is held near Soldier Field immediately following the finish of the 10K and 5K events from 7 a.m. to 10:30 a.m. The Post-Race Tailgate features music, food and beverages, as well as fun tailgate inspired games like a football toss and corn hole.

**You must be 21 years or older with a valid ID to purchase and/or consume alcoholic beverages at the Post-Race Tailgate.*

COURSE TIME REQUIREMENT

Participants must be capable of completing the full distance, start line to finish line, within the event time requirement of 1 hour, 35 minutes [15:00 per mile pace] for the 10K distance and 60 minutes [19:00 per mile pace] for the 5K distance.

TRANSPORTATION & PARKING

Waldron Parking Garage

Standard Parking manages the parking and on-site traffic operations at Soldier Field. Please visit soldierfieldparking.com for more information on race day parking.

PUBLIC TRANSPORTATION

Public transportation is strongly recommended for race day transportation to Soldier Field. Go to metra.com or transitchicago.com to plan your route by train or bus. If you drive, allow sufficient time for traffic congestion and street closures in the area due to the race and other events happening at McCormick Place and around Soldier Field.

SCHEDULE OF EVENTS

Saturday, July 13

Soldier Field, Chicago

- 5:30 a.m. Gear check opens
- 6:00 a.m. Start corrals open
- 7:00 a.m. 10K race start
- 7:00 a.m. Post-Race Tailgate starts
- 8:15 a.m. 5K race start
- 10:00 a.m. Beer last call
- 10:30 a.m. Gear check closes
- 10:30 a.m. Post-Race Tailgate ends